

# Gallo Xtra Laminate

Some products in this collection are discontinued.

## Benefits

### Family friendly (including pet)

Easy to clean  
Stain resistant, including pet stains  
Budget-friendly  
Water-resistant – 72-hour spill protection  
Ultra-durable and scratch-resistant surface

### Safe and healthy

FloorScore® Certified for compliance with rigorous indoor air quality requirements  
TSCA Title VI is a new standard of the Environmental Protection Agency (EPA) for allowable emissions from adhesives used in composite wood products. This certification ensures that certain wood products have reduced exposure to formaldehyde vapors and that are compliant to the new standards of the EPA.

### Performant and durable construction

Commercial abrasion resistance  
BLC Certified @ - Ensures that the floor covering you're buying surpasses industry quality standards.  
Ultra-durable and scratch-resistant surface

### Easy maintenance

Easy to clean  
Stain resistant, including pet stains  
Water-resistant – 72-hour spill protection

### Easy and versatile Installation

Floating installation  
Compatible with embedded radiant heating  
No telegraphing, even when installed over hard surface flooring  
Matching moldings available  
Can be installed on all floor levels, even on walls

### Notable look

Wide and long planks  
Matte finish

### Best-in-class Warranty

30 Days No Questions Asked Replacement

### Quickship

Stock product for faster delivery

# Gallo Xtra Laminate

## Product Specifications

<b>Market Segments</b>	Builder, Pro, Residential
<b>Sub Category</b>	Water-Resistant
<b>Collection</b>	Gallo Xtra
<b>Construction</b>	Laminate
<b>Format</b>	Plank
<b>Abrasion Resistance</b>	AC4 Class 32: General Commercial Use
<b>Species</b>	Oak
<b>Width</b>	7.68" (195 mm)
<b>Total Thickness</b>	0.327" (8.3 mm)
<b>Core Thickness</b>	n/a
<b>Backing</b>	n/a
<b>Edges</b>	4-Sided Micro Bevel & Wax
<b>Locking System</b>	Välinge 5G: Drop Lock
<b>Attached Backing</b>	No
<b>Backing Thickness</b>	None
<b>Finish</b>	Embossed
<b>Top Surface</b>	Aluminum Oxide
<b>Gloss</b>	Matte
<b>Pattern Repeat</b>	6
<b>IIC</b>	n/a
<b>STC</b>	n/a
<b>Formaldehyde</b>	TSCA Title VI
<b>Length</b>	47.835" (1215 mm)
<b>Certifications</b>	FloorScore, BLC Certification, QuickShip, TSCA Title VI Compliant
<b>Installation Methods</b>	Floating, Compatible with embedded radiant heating <a href="#">🔗 Laminate Installation Guide (Drop Lock)</a> <a href="#">🔗 Wall Installation Guide - Laminate</a> <a href="#">🔗 Laminate Installation Video - Välinge 5G Locking System</a>

## Warranties

- [🔗 Laminate Warranty Guide](#)
- [🔗 Laminate Maintenance Guide](#)

<b>Residential use</b>	Stain <i>Lifetime</i> No Questions Asked Replacement <i>30 days</i> Manufacturing Defects <i>Lifetime</i> Fade <i>Lifetime</i> Wear <i>Lifetime</i>
<b>Commercial use</b>	Stain <i>5 Years</i> Manufacturing Defects <i>5 Years</i> Fade <i>5 Years</i> Wear <i>5 Years</i>
<b>Light commercial use</b>	Stain <i>15 Years</i> Manufacturing Defects <i>15 Years</i> Fade <i>15 Years</i> Wear <i>15 Years</i>

# Gallo Xtra Laminate

## Packaging information

<b>Units Per Box</b>	8
<b>Boxes Per Pallet</b>	70
<b>Box Weight</b>	31.21 pounds (14157.51 grams)
<b>Square Meters Per Box</b>	1.90
<b>Square Meters Per Pallet</b>	132.66
<b>Square Feet Per Box</b>	20.4
<b>Square Feet Per Pallet</b>	1428

## Moldings



### **Flushmount Stair Nose - Round**

Matching  
94.488" X 0.945" X 2.756  
(2400 mm X 24 mm X 70 mm)

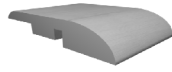

### **Reducer**

Matching  
94.488" X 0.433" X 1.771"  
(2400 mm X 11 mm X 45 mm)

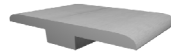

### **T-Molding**

Matching  
94.488" X 0.354" X 1.771"  
(2400 mm X 9 mm X 45 mm)

# Gallo Xtra Laminate

## Styles offered



**#8080 (Plank)**  
Agostino Xtra  
Embossed

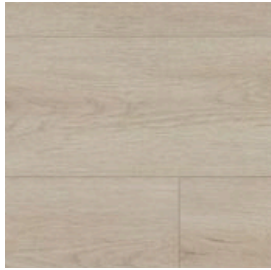

**#8081 (Plank)**  
Alboro Xtra  
Embossed



**#8082 (Plank)**  
Armoric Xtra  
Embossed

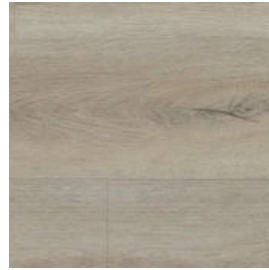

**#8083 (Plank)**  
Arzon Xtra  
Embossed



**#8084 (Plank)**  
Castello Xtra  
Embossed



**#8085 (Plank)**  
Gaelic Xtra  
Embossed



**#8086 (Plank)**  
Gondola Xtra  
Embossed

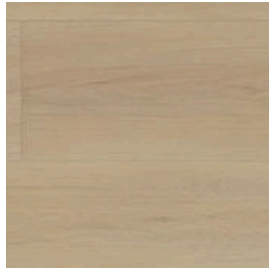

**#8087 (Plank)**  
Hermine Xtra  
Embossed

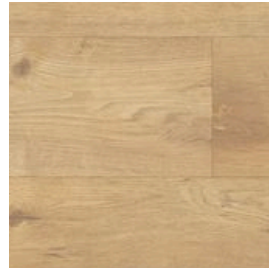

**#8088 (Plank)**  
Malo Xtra  
Embossed  
Limited Stock



**#8089 (Plank)**  
Renzo Xtra  
Embossed

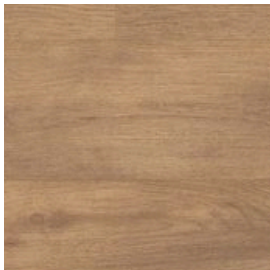

**#8090 (Plank)**  
Rialto Xtra  
Embossed

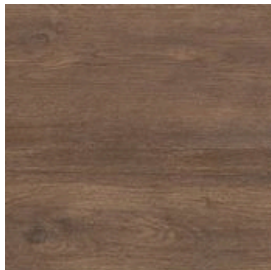

**#8091 (Plank)**  
Vaporetti Xtra  
Embossed